

# TURNY®

Makes it easier to enter  
and exit your car



For high-sill vehicles such as  
MPVs, SUVs, mini-buses or vans

 **auto<sup>®</sup>  
ADAPT**  
for your independence

INVENTIONS FOR QUALITY OF LIFE

# TURNY® HD

- with manual swivelling and electrically operated lifting and lowering!

TURNY HD swivels the car seat out through the door opening and lowers it to the correct position for comfortable transfer to or from a wheelchair. It offers manual swivelling and electrically operated lifting and lowering with a manual control. A wireless remote control is available as an optional extra and the lowering end stop is programmable.

TURNY HD is available in two lifting heights (300 and 395 mm) adapted to a variety of car types and user needs. This product is suitable for high-sill vehicles such as MPVs, SUVs, mini-buses and vans.

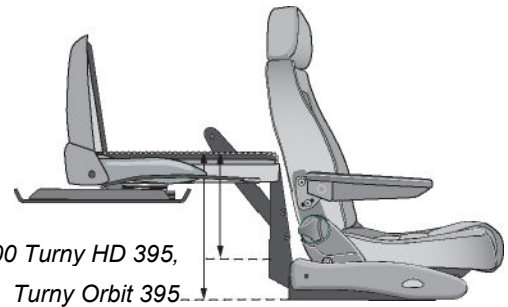

Turny HD 300, Turny Orbit 300 Turny HD 395,

Turny Orbit 395



Turny HD fitted with the BEV-seat (an optional extra).



## Colour options

The Turny covers are available in two colour options:

**Grey**, as shown in the pictures to the left and

**Tan**, as in picture below.



TURNY HD can be installed in the passenger seat or the central row at the rear and provides a safe means of transport for the mobility-impaired, as the original three-point car belt is retained. To save space, installation is recommended with a low-level car seat such as the BEV, which is easily adapted to the user's special needs and offers a wide range of practical accessories to ensure maximum seating comfort.

The product is installed in the original car-seat mounts in the floor, which in the majority of cases causes no damage to the vehicle, and it can also be transferred when necessary to another vehicle.

TURNY HD is CE- and E-marked and approved for a lifting capacity of 150 kg. It has also been subjected to crash, tensile and load tests.

Turny HD and Turny Orbit are operated with a manual control. A remote control is available as an optional extra.



TURNY HD has electrically operated lifting and lowering, while inward and outward swivelling is done manually by lifting the release lever by the side of the car seat.

# TURNY® + CARONY®

Turny in combination with the unique Carony system from Autoadapt



## CARONY 12" fixed®

**CARONY Fixed** eliminates lifting by the attendant and simplifies transfer to and from the vehicle. A couple of simple hand movements allow a single person to transfer the chair and passenger from the wheelchair base to the passenger seat. This is done without any lifting and so avoids arm and back strain. The compact wheelchair base is stored in the trunk when not in use. CARONY Fixed is CE-marked.

CARONY Fixed is a specially designed CARONY model that is used in combination with the TURNY car seat lift. Its continuously adjustable lifting and lowering function allows it to dock with the CARONY Fixed base, which has a set standard height. The set of pictures below illustrates passenger transfer from a CARONY Fixed to a TURNY Orbit in a mini-bus.



1. Swivel Turny outwards and lower to a suitable height.



2. Transfer the chair to the rails.

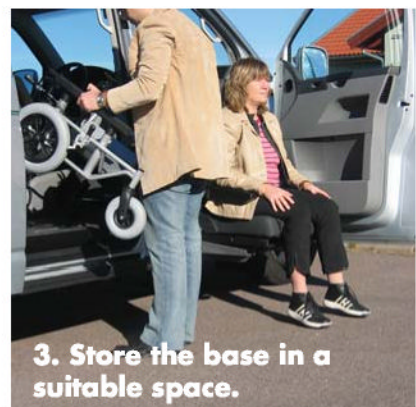

3. Store the base in a suitable space.



4. Use the manual control for lifting and inward swivelling.



5. Swivel Turny inwards to the passenger seat in the vehicle.

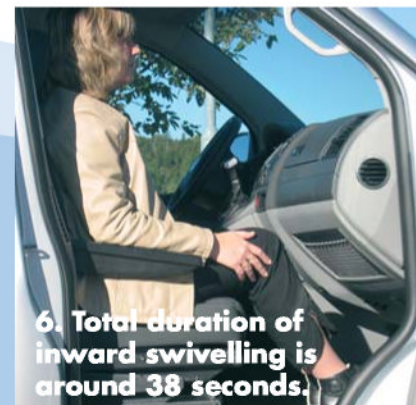

6. Total duration of inward swivelling is around 38 seconds.

## Protective bag for the belt cartridge

Art. No: 416093

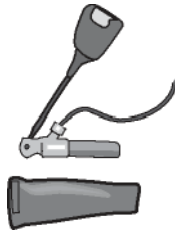

In most cases, the belt cartridge is located together with the original belt catch, whose use is recommended. The protective bag for the belt cartridge protects against external damage.

## Protective bag for the sensor mat

Art. No: 415918

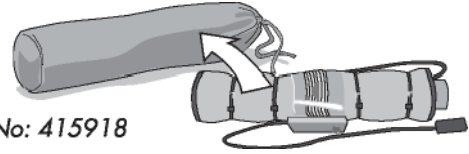

In certain vehicles, a mat with contacts is located beneath the seat cushion upholstery and detects whether the seat is occupied. This mat must be activated to retain airbag system functions after Turny is installed. The mat is therefore removed from the original seat, rolled up and placed in a protective bag. The mat connector is then re-connected to the car airbag system.

## Remote control

Art. No: 101144



## Template tool

Art. No: Right 100878  
Left 100888

There is a lightweight product model as an aid to making templates for Turny. It comprises a mounting plate and a swivel plate cut to the Turny's exact measurements and with the identical function so as to facilitate finding the location and measuring out the anchorage points.

## Folding foot support

Art. No: 101292

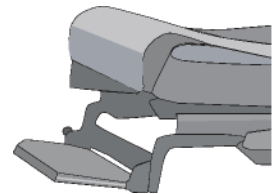

## Car seat rails



Art. No: 100505

Double-locked car seat rails to allow better adjustment of the seatback rake on the BEV or Recaro seat.

## Carony roller section

Art. No: Right 412119  
Left 412833

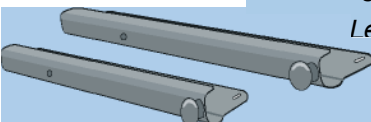

For Turny, only the 475 mm roller section is used.

## Brand-adapted mounting brackets

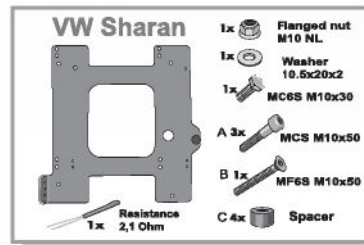

## Height-raising kit

Art. No: 100728, 70mm  
101227, 35 mm

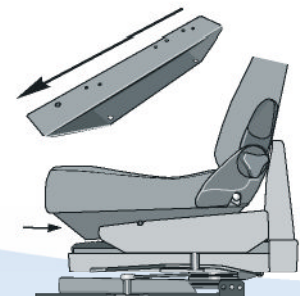

A car seat accessory in the Turny system.

On some vehicles the height of the original seat is so great that after installing Turny, it is necessary to raise the seat a bit to reach the correct seating level.

Turny should be installed as close to the floor as possible on account of its center of gravity. The kit should be installed between the car seat and Turny (also prepared for the Carony system).



Crash test of a Turny Orbit in a Toyota Sienna.



	<b>Turny HD</b>	<b>Turny Orbit</b>
Vertical motion:	300 mm, 395 mm	300 mm, 395 mm
Installed height:	165 mm	165 mm
Maximum user weight:	150 kg	150 kg

Turny HD and Turny Orbit meet the current requirements specified in EU directives: 72/245/EEG to 95/54/EG, 74/60/EEG to 2000/4/EG, 74/408/EEG to 96/37/EG, 76/115/EEG to 96/38/EEG, 93/42/EEG, 95/28/EG, 89/392/EEG to 98/37/EG as well as ECE R-10, ECE R-14, ECE R-17 and also FMVSS 201, 207, 208, 209, 210 and 302.



Turny HD and Turny Orbit are E-marked, which indicates compliance with the United Nations global motor vehicle regulations. E-marking is a type approval and is issued in Sweden by the Swedish Road Administration.



For more information

[www.autoadapt.com](http://www.autoadapt.com)

**Autoadapt AB**

Åkerivägen 7, S-443 61 Stenkullen, Sweden

Phone: +46 302 25400

E-mail: [contact@autoadapt.se](mailto:contact@autoadapt.se)

[www.autoadapt.se](http://www.autoadapt.se)

**Autoadapt UK Ltd**

Unit 4 Windsor Industrial Estate Rupert

Street, Aston B7 4, Birmingham UK

Phone: +44 (0)121 333 5170

E mail: [contact@autoadapt.co.uk](mailto:contact@autoadapt.co.uk)

[www.autoadapt.co.uk](http://www.autoadapt.co.uk)